



# bar

With patented self-setting:

## bar-miniswitch



The smallest opto-electrical  
position indicator in the world

## bar-miniswitch

The opto-electrical position indicator **bar-miniswitch** was especially conceived for smaller actuators. It requires a minimum of space for mounting.

The electrical connections are pluggable. The **bar-miniswitch** sets the switching point of the end position itself. Therefore it does not need to be opened, either for adjusting or for electrical connection.

**One very special feature:  
a patented system sets the switching  
point of the end position by itself!**

### Mounting sizes 50x25

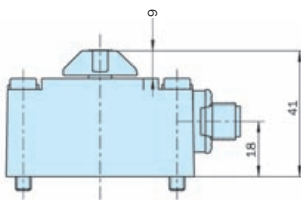

For shaft extension 15  
**MS-M2-50/25-15** and  
**MS-D2-50/25-15**

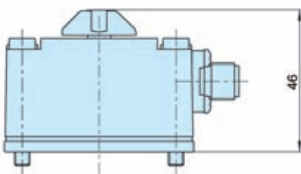

For shaft extension 20  
**MS-M2-50/25-20** and  
**MS-D2-50/25-20**

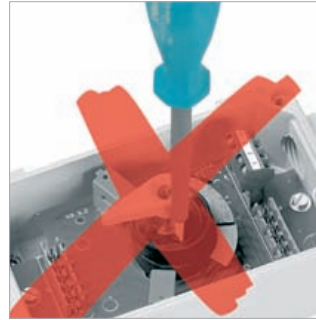
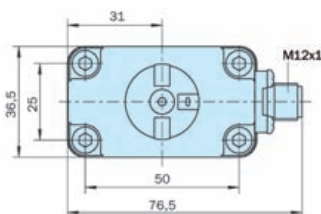

Setting of an end position  
is no longer needed!



bar-miniswitch + accessories:  
straight and angled connectors  
as well as cable connector

## Special features

- The optimum solution for the smallest of actuators.
- Available for mounting sizes 50x25 mm and 80x30 mm.  
For pinion extensions 15, 20 and 30 mm.
- Available for mechanical and inductive switches.
- Self-setting switching point of both end positions.
- Easy-to-read position indicator.
- All components made from corrosion-resistant or protected materials.
- Closed, direct mounting.
- Pluggable, electrical connections with various plug types.



bar-miniswitch ...  
Mounting size 50/25 mm  
Shaft extension 15 mm



... with 2 distance plates  
and adapter plate  
Mounting size 80/30 mm  
Shaft extension 30 mm

## Uses

Space-saving and harmonious proportions.

Flexible usage possibilities.

Wide-ranging application possibilities.

Time and cost savings.  
Switching points are always correctly set.

Clearly recognisable flow routes  
not only with 2/2-way but also 3/2-way valves.

Usable under a wide range of environments.

Protects the drive pinion;  
compact, space-saving design.

Can be exchanged without professionals.

## Mounting sizes 80x30

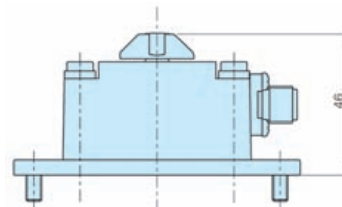

For shaft extensions 20  
**MS-M2-80/30-20** and  
**MS-D2-80/30-20**

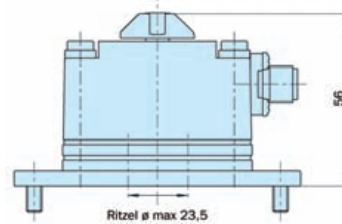

For shaft extensions 30  
**MS-M2-80/30-30** and  
**MS-D2-80/30-30**

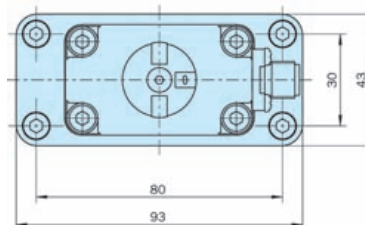

## Connectors:

(Please order separately)

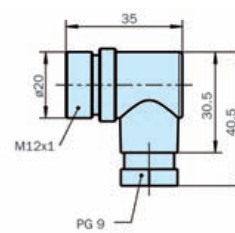

### Type W12

Connector  
with screw terminal  
angled

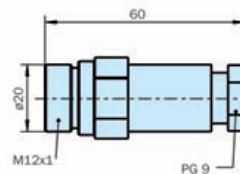

### Type G12

Connector  
with screw terminal  
straight

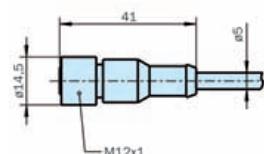

### Type K12

Connector  
with cable connection  
(2 m long)

## Technical Data

<b>Description</b>	Compact form, direct-mount
<b>Mounting size</b>	50x25 mm, shaft extension 15 mm + 20 mm with adapter: 80x30 mm, shaft extension 20 i.e. 30 mm
<b>Constructional features</b>	self-setting, with mechanical microswitches or inductive switches for actuators with 90° pivoting angle; on request for 180° pivoting angle
<b>Mounting position</b>	as desired
<b>Protection type</b>	IP 67
<b>Input voltage</b>	- mechanical: max. 250 V/AC, direct current max. 1 A - inductive: 5 bis 30 V/DC, direct current max. 100 mA
<b>Material</b>	- casing: POM - screws: stainless steel A2
<b>Switching functions</b>	- mechanical: changer - inductive: PNP closer
<b>Ambient temperature</b>	- mechanical: -20° bis +90° C - inductive: -20° bis +70° C
<b>Connection</b>	plug-connector M12x1, 4-pole DIN EN 61076-2-101
<b>Weight</b>	80 - 130 g, depending on model

## Switching diagrams

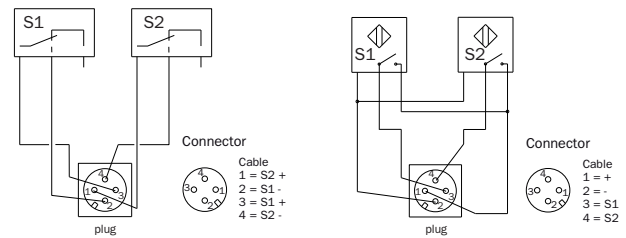

Microswitch type **M2**

Inductive switch type **D2**

## Type-code

**MS M2 50/25 15 - AW**

<b>MS</b>	<b>M2</b>	<b>50/25</b>	<b>15</b>	<b>-</b>	<b>AW</b>
<p><b>Connectors:</b>  <b>AW</b> = with screw terminal, angled  <b>AG</b> = with screw terminal, straight  <b>AK</b> = with cable connection                  (2 m long)</p> <p><b>Shaft extension:</b>  <b>15</b> or <b>20</b> or <b>30</b></p> <p><b>Mounting size:</b>  <b>50/25</b> or <b>80/30</b></p> <p><b>Switch type</b>  <b>M2</b> = microswitch  <b>D2</b> = inductive, direct-switch</p> <p><b>Type MS</b> = miniswitch</p>					

## bar GmbH

Auf der Hohl 1  
53547 Dattenberg/Germany

Tel. +49 (0) 2644 - 96070  
Fax +49 (0) 2644 - 960735

www.bar-gmbh.de  
sales@bar-gmbh.com

[www.bar-gmbh.de](http://www.bar-gmbh.de)